

PRODUCT DESCRIPTION

Rosco Quick Color Sleeves simplify the process of adding filter to almost any fluorescent source. Choose from among the entire range of Rosco filters to add color, balance color temperature or block harmful UV rays. A flat, welded envelop of Rosco gel, the Quick Sleeve easily puffs open to slide down directly onto a fluorescent lamp. Available in standard sizes for T5, T8 or T12 lamps in nominal 22.5in, 48in or 60in lengths, Quick Sleeves can also be special ordered for less common fluorescent sizes and shapes – including the diverse array of compact fluorescent lamps. Any color of Rosco gel can be made into a Quick Sleeve with no minimum order requirements. Unlike rigid tube guards, these lightweight sleeves fold flat for fast inexpensive shipping.

- Any Rosco gel color available with no minimum order
- T5, T8 or T12 standard diameters. Custom tubes available upon request.
- 22.5in, 48in, 60in standard lengths. Custom lengths available upon request.
- Easily cut with scissors or razor knife
- RoHS Compliant
- Meets International Flame Retardant standards. Certification documents available upon request.
- One Year color fast warranty on standard fluorescent lamps. (excludes HO or VHO lamps)

PRODUCT NUMBERS

QuickColor Sleeve: 110-08430- AA - BB -COLOR

AA = Length. Use "48" for 4' Fluorescent lamps.
Use "XX" for custom length.

BB = Diameter.
Use "12" for T12, "08" for T8, "05" for T5

COLOR= Specify Rosco color number
(eg. "02" for Roscolux 02)

Example: 4' T8 with Roscolux 02 = 110-08430-4808-02

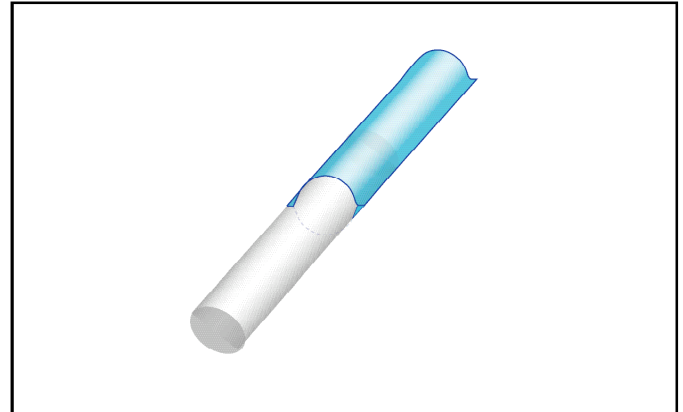

USAGE NOTES

*Rosco does not advise the use of QuickColor or Fluorescent Sleeves on High Output (HO) or Very High Output (VHO) lamps due to excessive heat generated at the electrodes. In some instances this can cause plastic color filters or tube guards to prematurely fail, or even melt.

The use of Rosco UV filter in QuickColor Sleeves or Fluorescent Sleeves may increase the durability of these products in typical installations. UV Filter will NOT prevent premature degradation on HO or VHO lamps.

Rosco Color Filters are made to exacting standards using the highest grade polymers and dyes stuffs available. However, due to variations among fixtures, ballasts, lamp types and UV output, the longevity of QuickColor Sleeves or Fluorescent Sleeves cannot be precisely determined. Color fading may occur over time.